



RS 1000

Ralle a sfera
 Ball Races
 Kugellenkränze
 Ronds d'avant train à billes

Tipo - Type - Typ - Type

SG

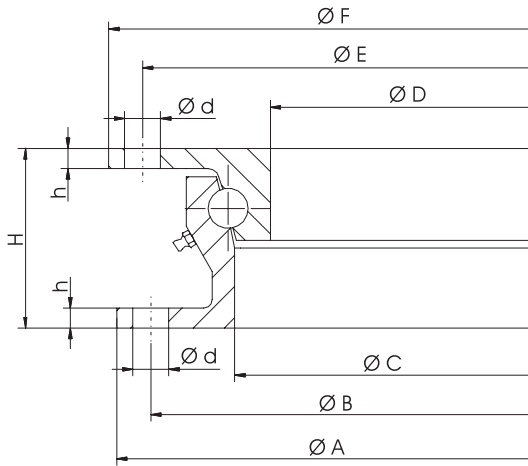

Tipo - Type - Typ - Type

SW

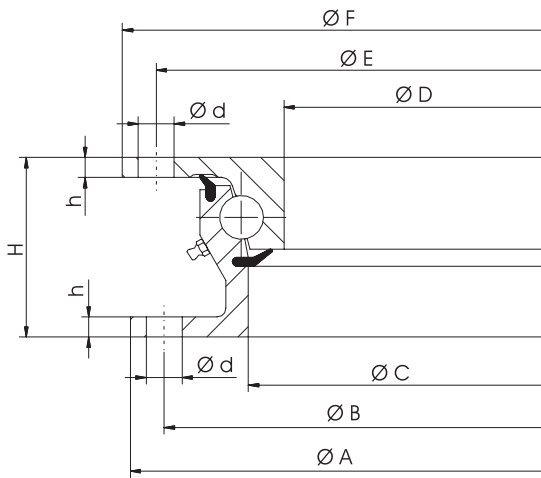

Tipo - Type - Typ - Type

DG

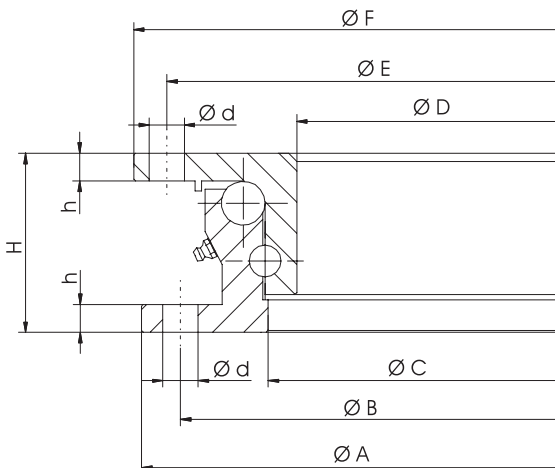

Anello inferiore
 Lower ring
 Unterer Ring
 Anneau inférieur

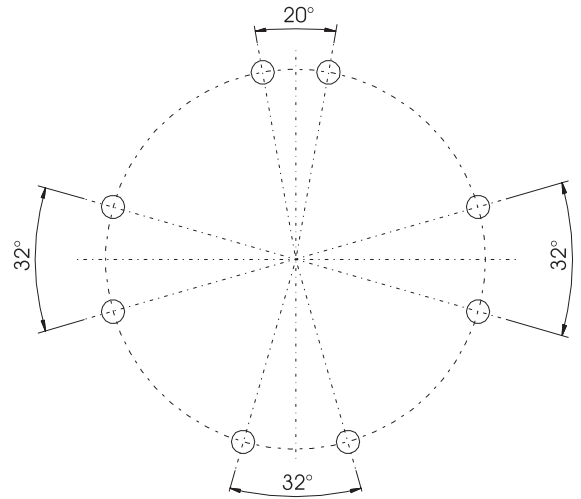

DIREZIONE DI MARCIA
 DIRECTION OF TRAVEL
 FAHRTRICHTUNG
 DIRECTION DE MARCHE

Anello superiore
 Upper ring
 Oberer Ring
 Anneau supérieur

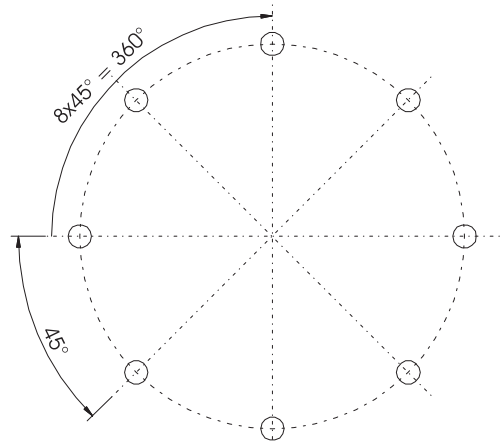

DIREZIONE DI MARCIA
 DIRECTION OF TRAVEL
 FAHRTRICHTUNG
 DIRECTION DE MARCHE

1990 439 C

RS 1000

Ralle a sfera
Ball Races
Kugellenkränze
Ronds d'avant train à billes

Dati tecnici - Technical data - Technische Daten - Données techniques

Tipo Type Typ Type	Codice Article number Artikelnummer Numéro d'ordre	Foratura Drilling Bohrloch Perçage	Carico assiale Axial load Achslast Charge axiale t	A mm	B mm	C mm	D mm	E mm	F mm	d mm	h mm	H mm	Peso Weight Gewicht Poids kg
SG	RSG0810	A	8	1000		877	846		1008		10	90	73
	RSG1010	A	10	1000		877	846		1008		10	90	73
	RSG1011	D	10	1100	1060	977	946	1074	1108	18	10	90	80
	RSG1211	D	12	1100	1060	977	946	1074	1108	18	10	90	80
	RSG1312	D	13	1200	1160	1077	1046	1174	1208	18	10	90	87
	RSG1510	A	15	987		846	829		1000		14	63	60
	RSG2210	A	10	1000		885	860		1015		15	90	85
	RSG2211	A	12	1100		983	949		1111		15	90	95
SW	RSW0810	A	8	1000		877	846		1008		10	90	73
	RSW1010	A	10	1000		877	846		1008		10	90	73
	RSW1011	D	10	1100	1060	977	946	1074	1108	18	10	90	80
	RSW1211	D	12	1100	1060	977	946	1074	1108	18	10	90	80
	RSW1312	D	13	1200	1160	1077	1046	1174	1208	18	10	90	87
DG	RDG1610	A / D	16	987	952	871	834	966	1000	18	14	90	92
	RDG2011	A / D	20	1100	1060	975	940	1074	1108	18	15	92	96

Ex: Codice d'ordine / Set-Orden number
Set-Bestellnummer / Set-Numéro d'ordre

Ralla a sfera - Ball races - Kugellenkränze
Ronds d'avant train à billes

R S G 08 10 A

Corone sfere - ball ring
Kugelkranz - Couronne de billes

Tipo di manutenzione - type of maintenance
Art der Wartung - Type d'entretien

Carico assiale in ton - axial load in tons
Achslast in Tonnen - Charge axiale en tonnes

Diametro esterno max. - maximum outside diameter
maximaler Außendurchmesser - Diamètre extérieur maximum

Foratura - drilling
Bohrloch - Perçage

S = singolo ricircolo di sfere
single recirculating ball
Einzelkugelumlauf
Recirculation de billes simple

D = doppio ricircolo di sfere
double recirculating ball
Doppelkugelumlauf
Recirculation de billes double

G = manutenzione standard
standard maintenance
Standardwartung
Entretien standard

W = manutenzione ridotta
reduced maintenance
Eingeschränkte Wartung
Entretien réduit

A = non forata
not drilled
nicht durchbohrt
non percée

D = forata
drilled
durchbohrt
percée